

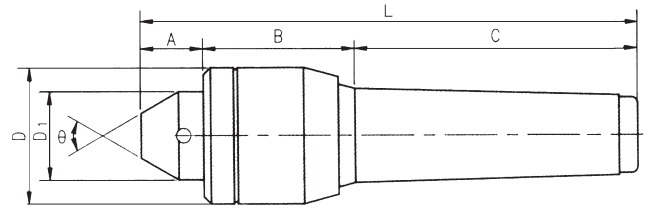

Inter-changeable Points Live Center

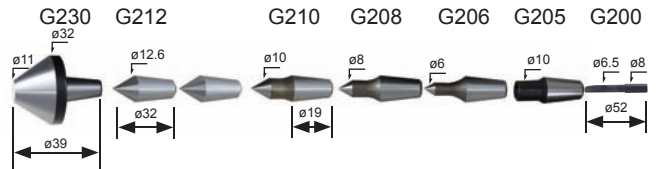

- Complete set with 7 Interchangeable Points for various processing.
- Packed in case.
- High accuracy and durability as well as complete rust-proof performance
- Center made of SCM420 special tool steel hardened and ground can be used for heavy duty work.



※Suggested tailstock pressure under 6 kg/cm²

Unit:mm

ORDER NO.	TYPE	A	B	C	D	D1	L	Accuracy	Speed Max. R.P.M.	θ	G.W. weight kgs	PACKING LxWxH	CODE NO.
VLC-312	MT2	22	36	69	32	25	127	0.008	4000	60°	0.9	166 x 105 x 63	5001-040
VLC-313	MT3	23	44	86	41	30	153	0.008	3000	60°	1.4	255 x 138 x 100	5001-041
VLC-314	MT4	23	51	108	47	32	182	0.008	2500	60°	2	255 x 138 x 100	5001-042



High Speed NC Interchangeable Points Live Center

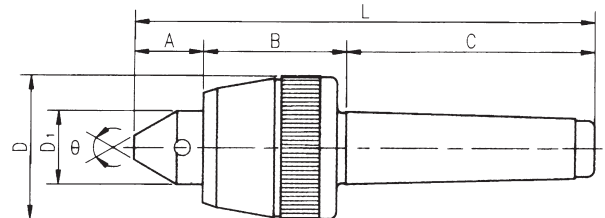

VCS-MT3, MT4

VCS-MT4P, MT5P

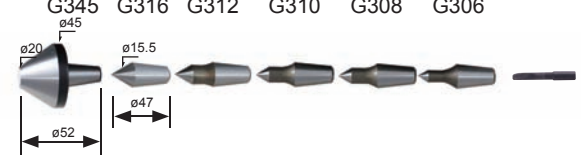
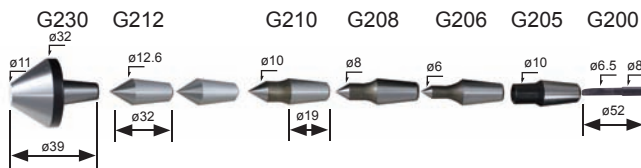

- Center shaft is made of SUJ2 material under vacuum heat treatment to provide higher rigidity (HRC60°±2°) and satisfied wear-resistance.
- Center is constituted by dual ball bearing. Thrust bearing & needle roller bearing assembly.
- Suit for to high-speed lathe & NC leathe with heavy load, water-proof.

※Suggested tailstock pressure under 6 kg/cm²

Unit:mm

ORDER NO.	A	B	C	D	D1	L	Accuracy	Speed Max. R.P.M.	θ	G.W. weight kgs	PACKING LxWxH	CODE NO.
VCS-MT3	28	51	86	53	30	165	0.008	4000	60°	1.8	255 x 138 x 100	5001-050
VCS-MT4	30	62	108	63	32	196	0.008	3500	60°	2.5	255 x 138 x 100	5001-051
VCS-MT4P	30	62	108	63	32	196	0.008	3500	60°	2.7	235 x 130 x 80	5001-052
VCS-MT5P	34	71	136	83	40	237	0.008	2500	60°	5.1	275 x 147 x 97	5001-053