

**NEW**



### Feature

- For Checking Roundness & True Running Accuracy
- For Grinding High Accuracy Outer Diameter & Round Bar On Surface Grinder By Accurated Center And Holder.

### Specification

- Body Center height : 85 mm
- Base to punch center : 109 mm
- Division & Accuracy : 24 & 15"±10"
- Workpiece length : 0~450mm
- Material : sks-3, HRC 60~62°
- Roundness : 0.002 mm
- Parallelism : 0.002 / 100mm
- Squareness : 0.002 / 100mm

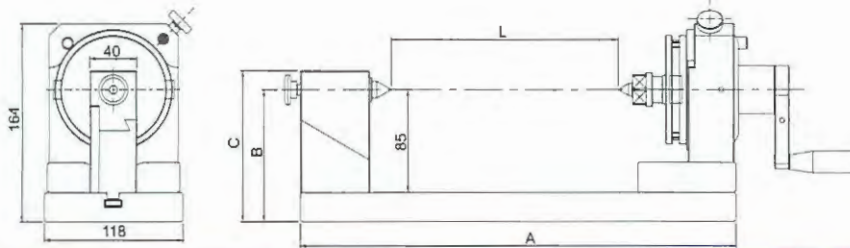

Unit:mm

ORDER NO.	A	B	C	L	Division	Graduation	N.W. (kgs)	CODE NO.
VCI-150P	375	109	125	0-150	24 (15"±10")	360°	20	2021-113
VCI-250P	475	109	125	0-250			23	2021-114
VCI-350P	575	109	125	0-350			26	2021-115

# Fixed Speed Punch Former

**AUTO TYPE**

**NEW**

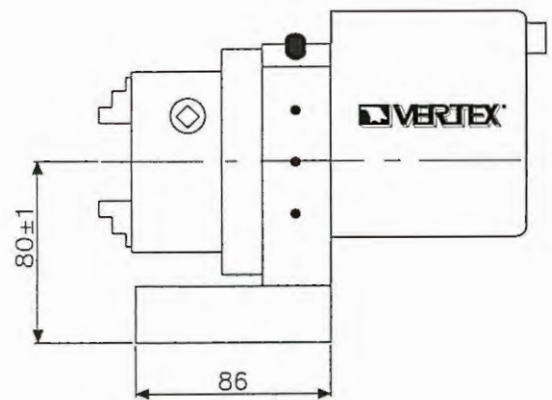

- The Punch Former with a motor attached can be applied to precisely grind a punch to round in a short time and saves the processing time.
- Chuck Type can clamp workpieces in a wide range.
- 3 inch 3 jaw chuck.

ORDER NO.	O.D.	I.D.	Max. Dia. of Workpiece	Center Height	Motor Output-W Input-V	Graduation	R.P.M.	N.W. (kgs)	CODE NO.
V-PS-80M	2-70	24-64	Ø50	80-81	15W 110/220V	360°	110	11.72	2021-130