

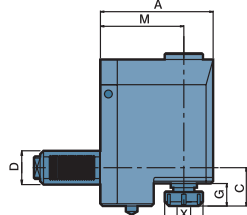

Radial Drilling And Milling Heads-Back Ward Type

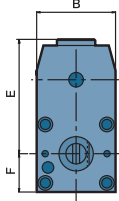

MODE: BL
LEFT-HAND



MODE: BR
RIGHT-HAND

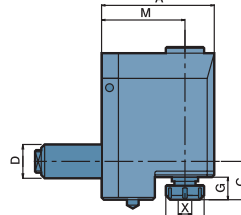
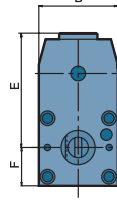

DIN 1809

- External coolant supply
- Collet is not included
- To be used for collet DIN 6499

DIMENSIONS

ORDER NO.	D DIN 69880	X Capacity	S	Maximum R.P.M.	i	A	B	C	E	F	G	M	CODE NO.
BR2018091660 BL2018091660	20	1-10 ER16	30	5000	1 : 1	83	50	35	70	27	27	60	5006-015A
BR3018092572 BL3018092572	30	1-16 ER25	42	5000	1 : 1	95	60	41.5	75.5	31.5	29	72	5006-016A
BR4018093290 BL4018093290	40	2-20 ER32	50	5000	1 : 1	124	80	44	110	42	34	90	5006-017
BR5018094090 BL5018094090	50	3-26 ER40	63	5000	1 : 1	129	86	49	112	45	39	90	5006-018
BR60180950106 BL60180950106	60	10-34 ER50	78	5000	1 : 1	154	104	74.5	123	54	52	106	5006-019A



Radial Tapping Heads-Back Ward Type

DIMENSIONS

DIN 1809

ORDER NO.	D DIN 69880	X Capacity	S	Maximum R.P.M.	i	A	B	C	E	F	G	M	CODE NO.
TBR3018091672 TBL3018091672	30	1-10 ER16	30	3000	1 : 1	95	60	44	75.5	31.5	32	72	5006-020A
TBR4018092090 TBL4018092090	40	1-13 ER20	35	3000	1 : 1	124	80	59.5	110	42	49.5	90	5006-021
TBR5018092590 TBL5018092590	50	1-16 ER25	42	3000	1 : 1	129	86	54	112	45	36	90	5006-022
TBR60180932106 TBL60180932106	60	2-20 ER32	50	3000	1 : 1	154	104	105	123	54	82.5	106	5006-023A



Radial Drilling And Milling Heads

※ ORDER MADE, NOT REFUNDABLE.

DIN 1809

MODE: FL
LEFT-HAND

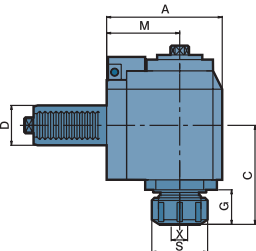
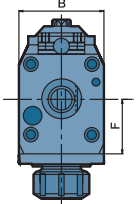

MODE: FR
RIGHT-HAND

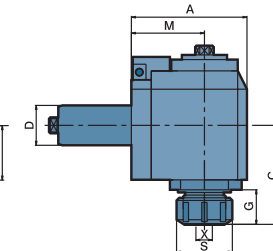
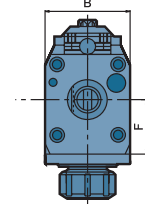

- To be used for collet DIN 6499
- Collet is not included
- External coolant supply

DIMENSIONS

ORDER NO.	D DIN 69880	X Capacity	S	Maximum R.P.M.	i	A	B	C	F	G	M	CODE NO.
FR3018092555 FL3018092555	30	1-16 ER25	42	5000	1 : 1	87	64	74.5	34	26	55	5006-024
FR4018093265 FL4018093265	40	2-20 ER32	50	5000	1 : 1	99	80	71	40	23	65	5006-025
FR5018094075 FL5018094075	50	3-26 ER40	63	5000	1 : 1	115	88	101	56	34	75	5006-026



Radial Tapping Heads

DIMENSIONS

DIN 1809

ORDER NO.	D DIN 69880	X Capacity	S	Maximum R.P.M.	i	A	B	C	F	G	M	CODE NO.
TFR3018091655 TFL3018091655	30	1-10 ER16	30	3000	1 : 1	87	64	75	41	30	55	5006-027
TFR4018092065 TFL4018092065	40	1-13 ER20	35	3000	1 : 1	99	80	93.5	40	46	65	5006-028
TFR5018092575 TFL5018092575	50	1-16 ER25	42	3000	1 : 1	115	88	103	56	42	75	5006-029