

BT-SK Collet Chuck System



JIS STD. 15000 R.P.M. 2.5G

AA

- THE SK CHUCK IS ACCORDING TO THE DESIGN OF ANGEL 8 WITH HIGH ACCURACY AND HIGH GRIPPING RANGE. THE GRIPPING TORQUE IS HIGHER THAN STANDARD ER CHUCK.
- THE DYNAMIC BALANCE OF SK CHUCK CAN BE REACHED 15000RPM X 2.5G.

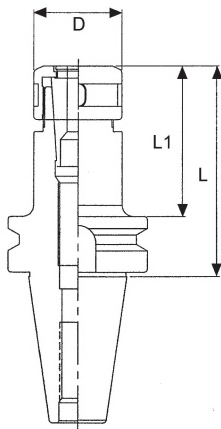
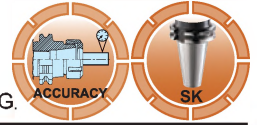

ORDER NO.	BT TYPE	COLLET TYPE	COLLET SIZE	D	L	L1	WEIGHT (kgs)	CODE NO.
SKB-201	BT-30-SK6-60	SK6	2-6	20	60	38	0.5	3218-600
SKB-202	BT-30-SK6-90	SK6	2-6	20	90	68	0.55	3218-601
SKB-203	BT-30-SK10-60	SK10	2-10	28	60	38	0.5	3218-602
SKB-204	BT-30-SK10-90	SK10	2-10	28	90	68	0.7	3218-603
SKB-205	BT-30-SK16-60	SK16	3-16	40	60	38	0.6	3218-604
SKB-206	BT-30-SK16-90	SK16	3-16	40	90	68	0.7	3218-605
SKB-207	BT-40-SK6-60	SK6	2-6	20	60	33	0.9	3218-606
SKB-208	BT-40-SK6-90	SK6	2-6	20	90	63	1	3218-607
SKB-209	BT-40-SK6-120	SK6	2-6	20	120	93	1.2	3218-608
SKB-210	BT-40-SK10-60	SK10	2-10	28	60	33	1	3218-609
SKB-211	BT-40-SK10-90	SK10	2-10	28	90	63	1.1	3218-610
SKB-212	BT-40-SK10-120	SK10	2-10	28	120	93	1.2	3218-611
SKB-213	BT-40-SK10-150	SK10	2-10	28	150	123	1.3	3218-612
SKB-214	BT-40-SK16-60	SK16	3-16	40	60	33	1.2	3218-613
SKB-215	BT-40-SK16-90	SK16	3-16	40	90	63	1.3	3218-614
SKB-216	BT-40-SK16-120	SK16	3-16	40	120	93	1.4	3218-615
SKB-217	BT-40-SK16-150	SK16	3-16	40	150	123	1.5	3218-616
SKB-218	BT-40-SK20-60	SK20	3-20	50	60	33	1.2	3218-617
SKB-219	BT-40-SK20-90	SK20	3-20	50	90	63	1.3	3218-618
SKB-221	BT-40-SK20-150	SK20	3-20	50	150	123	1.5	3218-620
SKB-222	BT-40-SK25-80	SK25	6-25	55	80	53	1.5	3218-621
SKB-223	BT-40-SK25-100	SK25	6-25	55	100	73	1.65	3218-622
SKB-224	BT-50-SK6-100	SK6	2-6	20	100	62	3.6	3218-623
SKB-225	BT-50-SK6-150	SK6	2-6	20	150	112	4	3218-624
SKB-226	BT-50-SK10-100	SK10	2-10	28	100	62	3.6	3218-625
SKB-227	BT-50-SK10-150	SK10	2-10	28	150	112	4	3218-626
SKB-228	BT-50-SK16-100	SK16	3-16	40	100	62	4	3218-627
SKB-229	BT-50-SK16-150	SK16	3-16	40	150	112	4.5	3218-628
SKB-230	BT-50-SK20-100	SK20	3-20	50	100	62	4.3	3218-629
SKB-231	BT-50-SK20-150	SK20	3-20	50	150	112	5.3	3218-630
SKB-232	BT-50-SK25-100	SK25	6-25	55	100	62	4.5	3218-631
SKB-233	BT-50-SK25-150	SK25	6-25	55	150	112	5.5	3218-632

Set Of SK Collet And MAS BT Chuck

DYNAMIC BALANCE TESTED

JIS STD.

15000 R.P.M.



AA



SK COLLET SET

METRIC RANGE SET SIZE
SK06/5pcs : Ø2, 3, 4, 5, 6
SK10/8pcs : Ø3, 4, 5, 6, 7, 8, 9, 10
SK16/8pcs : Ø3, 4, 6, 8, 10, 12, 14, 16
SK20/8pcs : Ø3, 4, 6, 8, 10, 12, 16, 20
SK25/7pcs : Ø6, 8, 10, 12, 16, 20, 25

ORDER NO.	BT TYPE	COLLET TYPE	SET RANGE	COLLET PCS	WEIGHT (kg)	CODE NO.
SKB-301	BT-30-SK6-60L	SK6	2-6	5	1.3	3218-640
SKB-302	BT-30-SK6-90L	SK6	2-6	5	1.45	3218-641
SKB-303	BT-30-SK10-60L	SK10	3-10	8	1.7	3218-642
SKB-304	BT-30-SK10-90L	SK10	3-10	8	1.9	3218-643
SKB-305	BT-30-SK16-60L	SK16	3-16	8	2.5	3218-644
SKB-306	BT-30-SK16-90L	SK16	3-16	8	2.8	3218-645
SKB-307	BT-40-SK6-60L	SK6	2-6	5	2.1	3218-646
SKB-308	BT-40-SK6-90L	SK6	2-6	5	2.3	3218-647
SKB-309	BT-40-SK10-60L	SK10	3-10	8	2.6	3218-648
SKB-310	BT-40-SK10-90L	SK10	3-10	8	2.8	3218-649
SKB-311	BT-40-SK16-60L	SK16	3-16	8	3	3218-650
SKB-312	BT-40-SK16-90L	SK16	3-16	8	3.3	3218-651
SKB-313	BT-40-SK20-60L	SK20	4-20	8	3.8	3218-652
SKB-314	BT-40-SK20-90L	SK20	4-20	8	4.1	3218-653
SKB-315	BT-40-SK25-80L	SK25	6-25	7	4.5	3218-654