



# U2 Collet System



NO.1 U2 COLLET RANGE SIZE 3~16mm

NO.2 U2 COLLET RANGE SIZE 18~25mm

NO.1



NO.2

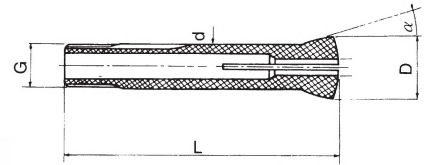

- L:120 ■ D:28 ■ d:20 ■ G:2.0P ■ Accuracy: ±0.02mm
- α:17°30' ■ WEIGHT:0.18KGS ■ Hardness: HRC47°

ORDER NO.	Q'TY	RANGE SIZE
VE-U2-□	1 PC	NO.1 Ø 1.5, 2, 3, 4, 5, 6, 7, 8, 9, 10, 11, 12, 13, 14, 15, 16 NO.2 Ø 18, 20, 25MM
VE-U2-□	1 PC	Ø 1/8", 3/16", 1/4", 5/16", 3/8", 1/2", 5/8"

mm			mm			inch		
ORDER NO.	d	CODE NO.	ORDER NO.	d	CODE NO.	ORDER NO.	d	CODE NO.
VE-U2-1.5	1.5	3207-026	VE-U2-10	10	3207-008	VE-U2-1/8	1/8"	3207-018
VE-U2-2	2	3207-027	VE-U2-11	11	3207-009	VE-U2-3/16	3/16"	3207-019
VE-U2-3	3	3207-001	VE-U2-12	12	3207-010	VE-U2-1/4	1/4"	3207-020
VE-U2-4	4	3207-002	VE-U2-13	13	3207-011	VE-U2-5/16	5/16"	3207-021
VE-U2-5	5	3207-003	VE-U2-14	14	3207-012	VE-U2-3/8	3/8"	3207-022
VE-U2-6	6	3207-004	VE-U2-15	15	3207-013	VE-U2-1/2	1/2"	3207-023
VE-U2-7	7	3207-005	VE-U2-16	16	3207-014	VE-U2-5/8	5/8"	3207-024
VE-U2-8	8	3207-006	VE-U2-18	18	3207-015			
VE-U2-9	9	3207-007	VE-U2-20	20	3207-016			
			VE-U2-25	25	3207-017			



# MT3 Collet System

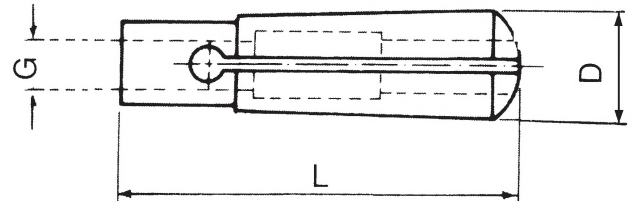

- D:24.1 ■ L:87 ■ WEIGHT:0.18KGS
- DRAW BAR SIZE: G1.M12X1.75P

ORDER NO.	Q'TY	RANGE SIZE	DRAW BAR SIZE
MT3-□	1 PC	Ø 4, 6, 8, 10, 12, 16, 20MM	G1

ORDER NO.	d	CODE NO.
MT3-4	4	3208-100
MT3-6	6	3208-101
MT3-8	8	3208-102
MT3-10	10	3208-103
MT3-12	12	3208-104
MT3-16	16	3208-105
MT3-20	20	3208-106