

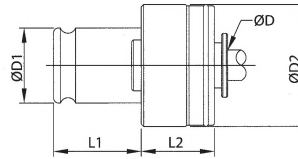

Quick Change Tapping Collet



QUICK CHANGE TAP COLLETS



With Overload Safety Collet

ANSI TYPE

ORDER NO.	Size	TC312 ANSI Tap	Tap Shank				Capacity	L1 L2 (mm)	ØD1 ØD2 (mm)	CODE NO.	ØD x □ Size same as ANSI			
			ØD		□									
			inch	mm	inch	mm								
TC312-#5-ANSI	TC312 ANSI	#5	0.141	3.581	0.11	2.794	#5~#14	21.5	Suit for DIA. 19.0	3404-701	UNC1/8", M3, M3.15			
TC312-#6-ANSI		#6	0.141	3.581	0.11	2.794				3404-702	M3.5			
TC312-#8-ANSI		#8	0.168	4.267	0.131	3.327				3404-703	UNC5/32", M4			
TC312-#10-ANSI		#10	0.194	4.928	0.152	3.861				3404-704	UNC3/16", M4.5, M5			
TC312-#12-ANSI		#12	0.220	5.588	0.165	4.191				3404-705				
TC312-#14-ANSI		#14	0.255	6.477	0.191	4.851				3404-706	UNC1/4", M6, M6.3			
TC312-M3-ANSI		M3	0.141	3.581	0.11	2.794				M3~M14	25.0	32.0	3404-707	#5, UNC1/8", M3.15
TC312-M4-ANSI		M4	0.168	4.267	0.131	3.327							3404-708	#8, UNC5/32"
TC312-M5-ANSI		M5	0.194	4.928	0.52	3.861							3404-709	#10, UNC3/16", M4.5
TC312-M6-ANSI		M6	0.255	6.477	0.191	4.851							3404-710	#14, UNC1/4", M6.3
TC312-M8-ANSI		M8	0.318	8.077	0.238	6.045							3404-711	UNC5/16", M7
TC312-M10-ANSI		M10	0.323	8.204	0.242	6.147							3404-712	UNC7/16"
TC312-M12-ANSI		M12	0.367	9.322	0.275	6.985							3404-713	UNC1/2", M12.5
TC312-M14-ANSI		M14	0.429	10.897	0.322	8.179							3404-714	UNC9/16"
TC312-UNC1/8-ANSI		UNC1/8	0.141	3.581	0.11	2.794	UNC1/8 UNC9/16	25.0	32.0				3404-715	#5, M3, M3.15
TC312-UNC3/16-ANSI		UNC3/16	0.194	4.928	0.152	3.861							3404-716	#10, M4.5, M5
TC312-UNC1/4-ANSI		UNC1/4	0.255	6.477	0.191	4.851				3404-717	#14, M6, M6.3			
TC312-UNC5/16-ANSI		UNC5/16	0.318	8.077	0.238	6.045				3404-718	M7, M8			
TC312-UNC7/16-ANSI		UNC7/16	0.323	8.204	0.242	6.147				3404-719	M10			
TC312-UNC1/2-ANSI		UNC1/2	0.367	9.322	0.275	6.985				3404-720	M12, M12.5			
TC312-UNC3/8-ANSI	UNC3/8	0.381	9.677	0.286	7.264	3404-721								
TC312-UNC9/16-ANSI	UNC9/16	0.429	10.897	0.322	8.179	3404-722				M14				

ANSI TYPE

ORDER NO.	Size	TC820 ANSI Tap	Tap Shank				Capacity	L1 L2 (mm)	ØD1 ØD2 (mm)	CODE NO.	ØD x □ Size same as ANSI
			ØD		□						
			inch	mm	inch	mm					
TC820-UNC7/16-ANSI	TC820 ANSI	UNC7/16	0.323	8.204	0.242	6.147	UNC7/16 UNC7/8	35.0	Suit for DIA. 31.0	3404-731	M10
TC820-UNC1/2-ANSI		UNC1/2	0.367	9.322	0.275	6.985				3404-732	M12, M12.5
TC820-UNC3/8-ANSI		UNC3/8	0.381	9.677	0.286	7.264				3404-733	
TC820-UNC9/16-ANSI		UNC9/16	0.429	10.897	0.322	8.179				3404-734	M14
TC820-UNC5/8-ANSI		UNC5/8	0.480	12.192	0.36	9.144				3404-735	M16
TC820-UNC11/16-ANSI		UN11/16	0.542	13.767	0.406	10.312	M6~M24	34.0	50.0	3404-736	M18
TC820-UNC3/4-ANSI		UNC3/4	0.590	14.986	0.442	11.227				3404-737	
TC820-UNC13/16-ANSI		UNC13/16	0.652	16.561	0.489	12.421				3404-738	M20
TC820-UNC7/8-ANSI		UNC7/8	0.697	17.704	0.523	13.284				3404-739	M22