



Mini Type Arm Type Air Tapping Unit



VERTEX®

HIGH TORQUE HIGH EFFICIENCY EASY OPERATION

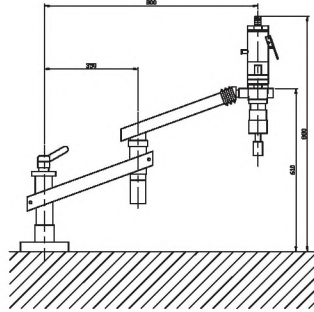

ACCESSORIES

- Air tapping spindle
- Parallel arm & Air combination
- Table mounting column
- Choose any six safety clutch tapping adapters
- Radial jib
- Air pressure: 6~8 kgs/cm²
- VAT-08/12 series require: 5HP compressor
- VAT-16/20 series require: 10HP compressor

※ GUARANTEED FOR 3 MONTHS.

※ MUST INSTALL ON A STABLE / HARD SURFACE FOR PARALLE WORK.

※ Base not included

ORDER NO.	VAT-708	VAT-712	VAT-716	VAT-720	VAT-722	VAT-724
For Tap	M3~M8	M5~M12	M8~M16	M10~M20	M12~M22	M14~M24
	TC-312	TC-312	TC-820	TC-820	TC-820	TC-820
Speed (rpm)	630/700	350/400	250	200	200	100
Weight (kgs)	13.2	13.1	17.3	20.6	20.6	22.1
Work Range	Rmax 700mm					
CODE NO.	3404-410	3404-411	3404-412	3404-413	3404-413A	3404-413B



Small Arm Type Air Tapping Unit

HIGH TORQUE HIGH EFFICIENCY EASY OPERATION

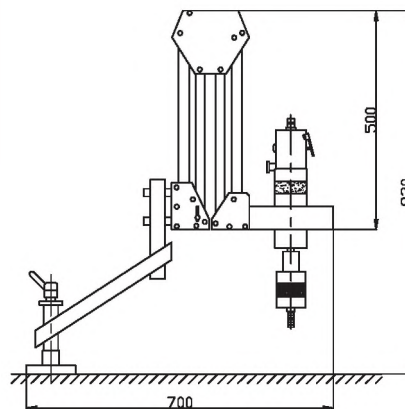

※ Base not included

ACCESSORIES

- Air tapping spindle
- Parallel arm & Air combination
- Table mounting column
- Choose any six safety clutch tapping adapters
- Radial jib, increases arm reach by 500 mm

- Without stand plate
- Air pressure: 6~8 kgs / cm²
- VAT-08/12 series require: 5HP compressor
- VAT-16/20 series require: 10HP compressor

※ GUARANTEED FOR 3 MONTHS.

※ MUST INSTALL ON A STABLE / HARD SURFACE FOR PARALLE WORK.

ORDER NO.	VAT-1408	VAT-1412	VAT-1416	VAT-1420	VAT-1422	VAT-1424
For Tap	M3~M8	M5~M12	M8~M16	M10~M20	M12~M22	M14~M24
	TC-312	TC-312	TC-820	TC-820	TC-820	TC820
Speed (rpm)	700	400	250	200	200	100
Weight (kgs)	18.2	18.2	24.6	25.6	25.6	27.1
Work Range	Rmax 1400mm Rmin 200mm					
CODE NO.	3404-415	3404-416	3404-417	3404-418	3404-418A	3404-418B

※ VAT-1424 can be replaced by VAT-1624



Arm Type Air Tapping Unit



HIGH TORQUE HIGH EFFICIENCY EASY OPERATION

WORK RANGE
1600X500m/m
RMAX. X MIN.

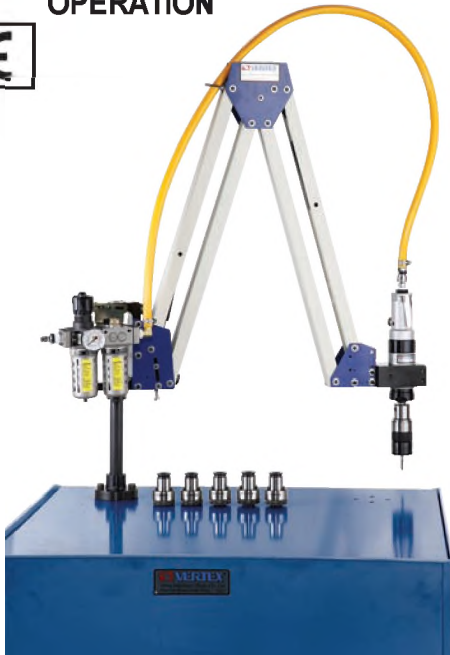

※Base not included

VAT-1608/1612/1616
VAT-1620/1622/1624

To solve all tapping problems

- Rapid positioning and high machining speed increase productivity.
- Lower tap damage rate, high thread accuracy.
- Tap shall never break for tapping through-hole or blind-hole.
- Tapping for heavier workpiece requires neither positioning equipments nor movement or large work area.
- Lower machining cost than that by CNC machine, drilling machine or manual tapping operation.
- Drilling to max: 6mm diameter
- Easy operation, no experience or strength required.
- Without stand plate.
- Air pressure: 6~8 kgs/cm²
- VAT-08/12 series require: 5HP compressor
- VAT-16/20 series require: 10HP compressor
- ※ GUARANTEED FOR 3 MONTHS.
- ※ MUST INSTALL ON A STABLE / HARD SURFACE FOR PARALLE WORK.

Suggest collet size for standard acces



VAT-□□**0**8 COLLET SIZE TC312-M3,M4,M5,M6*2,M8

VAT-□□**1**2 COLLET SIZE TC312-M5,M6,M8*2,M10,M12

VAT-□□**1**6 COLLET SIZE TC312/TC820

TC312-M8,M10

TC820-M10,M12,M14,M16

VAT-□□**2**0 COLLET SIZE TC820-M10,M12,M14,M16,M18,M20

VAT-□□**2**2 COLLET SIZE TC820-M12,M14,M16,M18,M20,M22

VAT-□□**2**4 COLLET SIZE TC820-M14,M16,M18,M20,M22,M24

JIS & DIN376 Most Populared

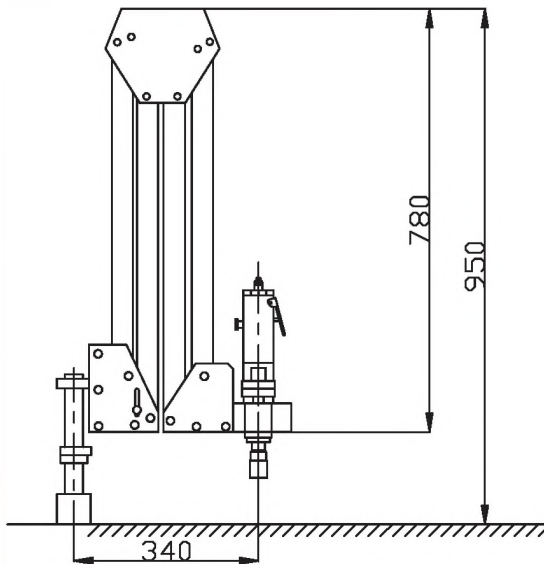

ORDER NO.	VAT-1608	VAT-1612	VAT-1616	VAT-1620	VAT-1622	VAT-1624
For Tap	M3~M8	M5~M12	M8~M16	M10~M20	M12~M22	M14~M24
	TC-312	TC-312	TC-820	TC-820	TC-820	TC-820
Speed (rpm)	700	400	250	200	200	100
Weight (kgs)	16.9	17	21.1	24.6	24.6	26.10
Work Range	Rmax 1600mm					
	Rmin 500mm					
CODE NO.	3404-420	3404-421	3404-422	3404-428	3404-428A	3404-428B

VAT-1608, 1612, 1616, 1620, 1622, 1624 STANDARD ACCESSORIES

- Air tapping spindle
- Parallel arm
- Table mounting column
- Air combination
- Choose any six safety clutch tapping adapters

Air Tapping Unit

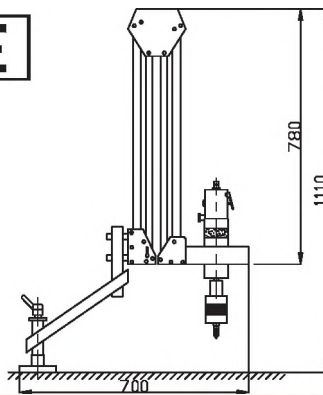

STANDARD ACCESSORIES:

- Air tapping spindle
- Parallel arm & Air combination
- Table mounting column
- Choose any six safety clutch tapping adapters
- Radial jib, increases arm reach by 500 mm
- Air pressure: 6~8 kgs / cm²
- VAT-08/12 series require: 5HP compressor
- VAT-16/20 series require: 10HP compressor

※Base not included

ORDER NO.	VAT-1908	VAT-1912	VAT-1916	VAT-1920	VAT-1922	VAT-1924
For Tap	M3~M8	M5~M12	M8~M16	M10~M20	M12~M22	M14~M24
	TC-312	TC-312	TC-820	TC-820	TC-820	TC-820
Speed (rpm)	700	400	250	180/200	185/205	90/100
Weight (kgs)	19.7	23.9	23.5	26	28	28
Work Range	Rmax 1900mm					
	Rmin 200mm					
CODE NO.	3404-425	3404-426	3404-427	3404-430	3404-431	3404-431A

※VAT-1924 can be replaced by VAT-1624

※GUARANTEED FOR 3 MONTHS.

Air Tapping Spindle

High torque, high efficiency for machining all tapping requirement. Light and handy main shaft design, easy operation.

The required pressure is 6.3kg/cm²=90 PSI.

- SP08 & SP12 Required 5 HP compressor and more.
 - SP16 & SP20 Required 10 HP compressor and more.
- (must keep the air pressure at 6.3kg/cm²)

※GUARANTEED FOR 3 MONTHS.

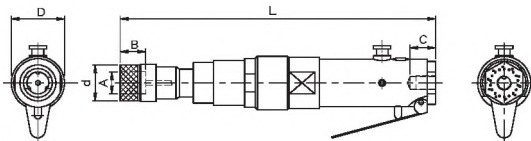

ORDER NO.	TAPPING CAPACITY	SPEED (rpm)	MOUNTING DIA.	WEIGHT (kgs)	CODE NO.
VAT-SP08	M3-M8	630/700	ø38.5 (1 1/2")	1.5	3404-432
VAT-SP12	M5-M12	350/400	ø38.5 (1 1/2")	1.5	3404-433
VAT-SP16	M8-M16	230/250	ø61.3 (2 13/32")	3.9	3404-434
VAT-SP20	M10-M20	180/200	ø61.3 (2 13/32")	3.9	3404-435
VAT-SP22	M12-M22	185/205	ø61.3 (2 13/32")	3.9	3404-435A
VAT-SP24	M14-M24	90/100	ø61.3 (2 13/32")	4.3	3404-435B

ORDER NO.	A	B	C	D	d	L	CODE NO.
VAT-SP08	19	30	22	46	32	263	3404-432
VAT-SP12	19	30	22	46	32	263	3404-433
VAT-SP16	31	48	27	65	50	360	3404-434
VAT-SP20	31	48	27	65	50	360	3404-435
VAT-SP22	31	48	27	65	50	360	3404-435A
VAT-SP24	31	48	27	65	50	395	3404-435B

Parallel Arm For Air Tapping Unit

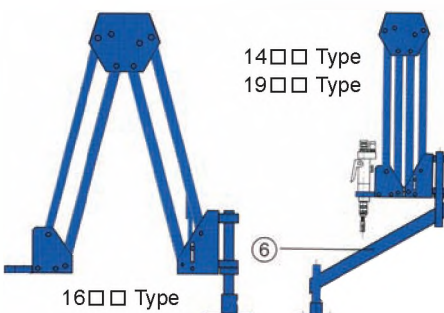

PARALLEL ARM

FOR THE AIR TAPPING UNIT

ORDER NO.	WEIGHT SP-08	WEIGHT SP-12	WEIGHT SP-16	CODE NO.
VAT-ARM700-SP ^{08, 12, 16}	12kgs	12kgs	14kgs	3404-436
VAT-ARM1400x200-SP ^{08, 12, 16}	17kgs	17kgs	18kgs	3404-437
VAT-ARM1600x500-SP ^{08, 12, 16}	17kgs	17kgs	18kgs	3404-438
VAT-ARM1900x200-SP ^{08, 12, 16}	19kgs	19kgs	20kgs	3404-439

※ MUST INSTALL ON A STABLE / HARD SURFACE FOR PARALLE WORK.