

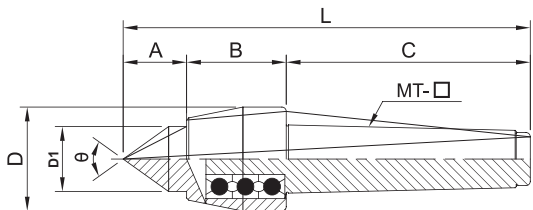

Light Duty Live Center

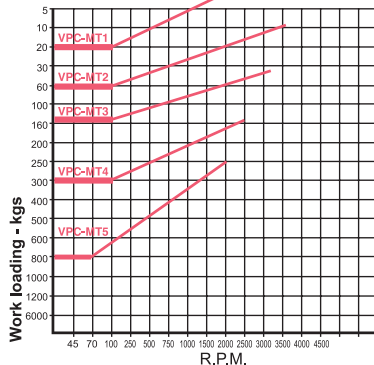

※Suggested tailstock pressure under 6 kg/cm²



FOR VPC-TYPE

- Center is made of SCM420 alloy steel by heat treatment to provide higher rigidity (HRC60°±2°) and satisfied wear-resistance.
- Center is constituted by ball bearings assembly.
- Applicable to middle-speed & high-speed lathe with light load.

Unit:mm

ORDER NO.	A	B	C	D	D1	L	Accuracy	Speed Max R.P.M.	θ	G.W. weight kgs	PACKING LxWxH	CODE NO.
VPC-MT1	21	31	56	32	16	108	0.005	3200	60°	0.3	115 x 136 x 38	5001-001
VPC-MT2	26	37	69	40	22	132	0.005	2800	60°	0.5	140 x 45 x 45	5001-002
VPC-MT3	32	46	86	45	26	164	0.005	2000	60°	0.9	170 x 50 x 52	5001-003
VPC-MT4	34	46	108	48	30	188	0.005	1800	60°	1.3	195 x 58 x 56	5001-004
VPC-MT5	50	62	136	68	45	248	0.005	1500	60°	3.2	268 x 86 x 77	5001-005