

Power Transmission According
To DIN 1809

- External coolant supply
- Collet is not included
- To be used for collet DIN 6499

DIMENSIONS

ORDER NO.	D DIN 69880	X Capacity	S	Maximum R.P.M.	i	A	B	C	CODE NO.
DA20180916	20	1-10 ER16	32	6000	1 : 1	77	49	58	5006-001
DA30180925	30	1-16 ER25	42	6000	1 : 1	101	70	68	5006-002
DA40180932	40	2-20 ER32	50	6000	1 : 1	111	73.5	86	5006-003
DA50180940	50	3-26 ER40	63	6000	1 : 1	120	81.5	96	5006-004
DA60180950	60	10-34 ER50	78	6000	1 : 1	140	88.5	116	5006-005



Axial Tapping Heads

DIMENSIONS

ORDER NO.	D DIN 69880	X Capacity	S	Maximum R.P.M.	i	A	B	C	CODE NO.
TDA30180916	30	1-10 ER16	30	3000	1 : 1	108	71.5	68	5006-006
TDA40180920	40	1-13 ER20	35	3000	1 : 1	95.5	55	86	5006-007
TDA50180925	50	1-16 ER25	42	3000	1 : 1	123	81.5	96	5006-008
TDA60180932	60	2-20 ER32	50	3000	1 : 1	158.5	88.5	116	5006-009



Axial Milling Heads

DIN 1809

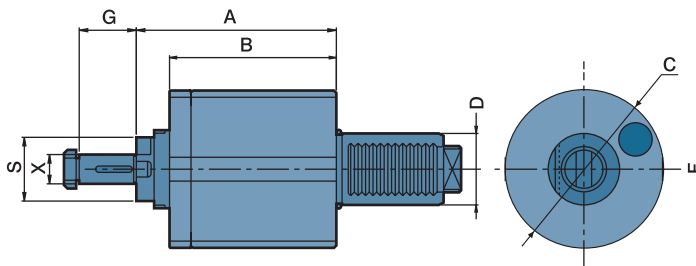

- External coolant and intermediate rings supply
- To be used for cutter arbor according to DIN 6358

DIMENSIONS

ORDER NO.	D DIN 69880	X Capacity	S	Maximum R.P.M.	i	A	B	C	G	CODE NO.
DA30180916C	30	16	32	3000	1 : 1	91.5	70	68	27	5006-010
DA40180922C	40	22	40	3000	1 : 1	86.5	73.5	86	31	5006-012
DA50180922C	50	22	40	3000	1 : 1	117	81.5	96	31	5006-013
DA50180927C	50	27	40	3000	1 : 1	117	81.5	96	33	5006-014